

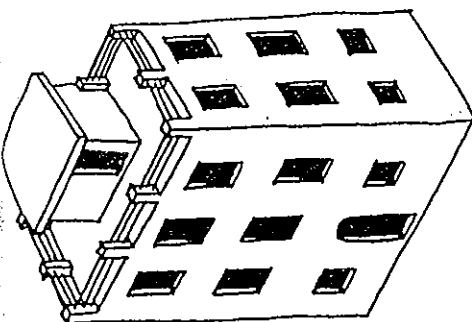

PROVINCIA DI LA SPEZIA
PIANO REGOLATORE GENERALE

AMBIENTALE

N° 1 (art. 43)



STATO DI FATTO

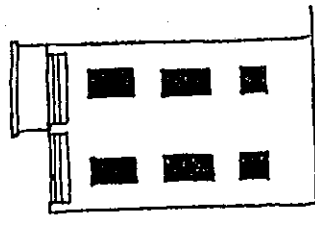
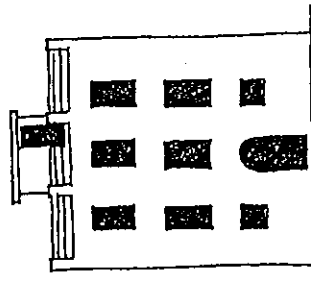

N. B. IL TIMPANO DEVE ESSERE
IMPOSTATO SUL LATO MINORE

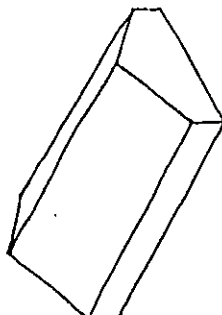

TIPOLOGIE AMMESSE

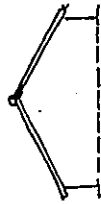

DUE FALDE "A CAPANNA" CON COLMO CENTRALE

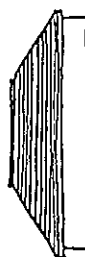
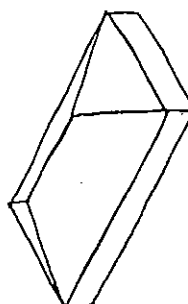

"A PADIGLIONE"





PROVINCIA DI LA SPEZIA
PIANO REGOLATORE GENERALE
N° 2 (art. 53)

PROVINCIA DI LA SPEZIA
PIANO REGOLATORE GENERALE



STATO DI FATTO

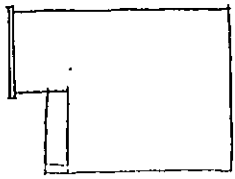
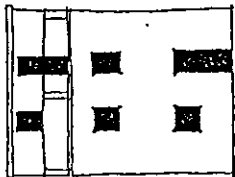
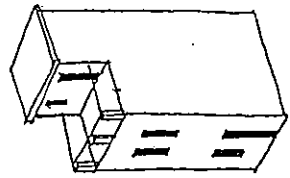

1° IPOTESI: TETTO A DUE FALDE

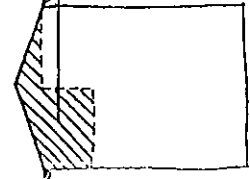
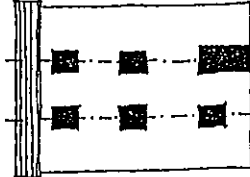
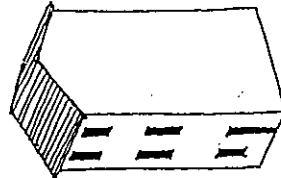

2° IPOTESI: TETTO A UNA FALDA

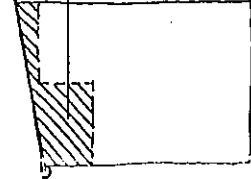
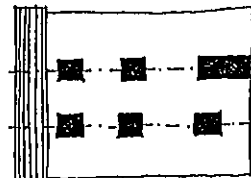
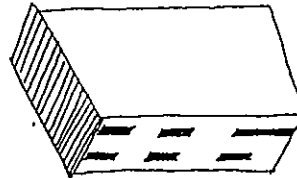

3° IPOTESI: TETTO A FALDE CON TERRAZZO

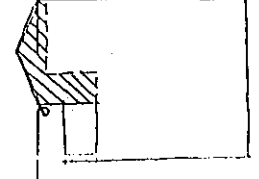
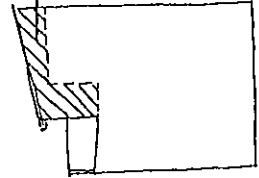
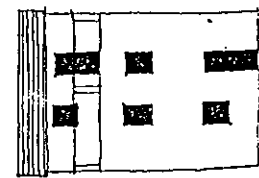

VOLUME ABITABILE
ASSERVITO ALLA
UNITA' IMMOBILIARE
SOTTOSTANTE

ELEMENTO DI SCHIERA

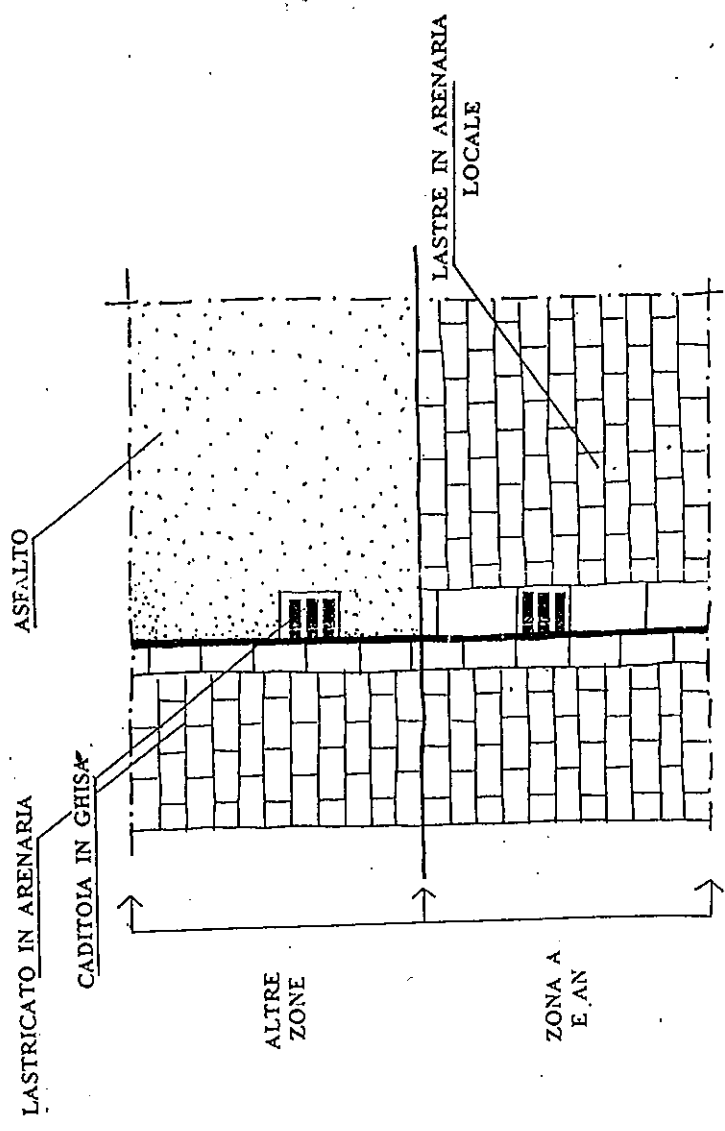

VIABILITA' CARRABILE PUBBLICA

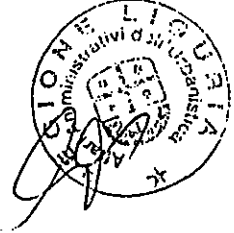

PAESAGGISTICA
AMBIENTALE

N°4 (art. 132)

PROVINCIA DI LA SPEZIA
PIANO REGOLATORE GENERALE

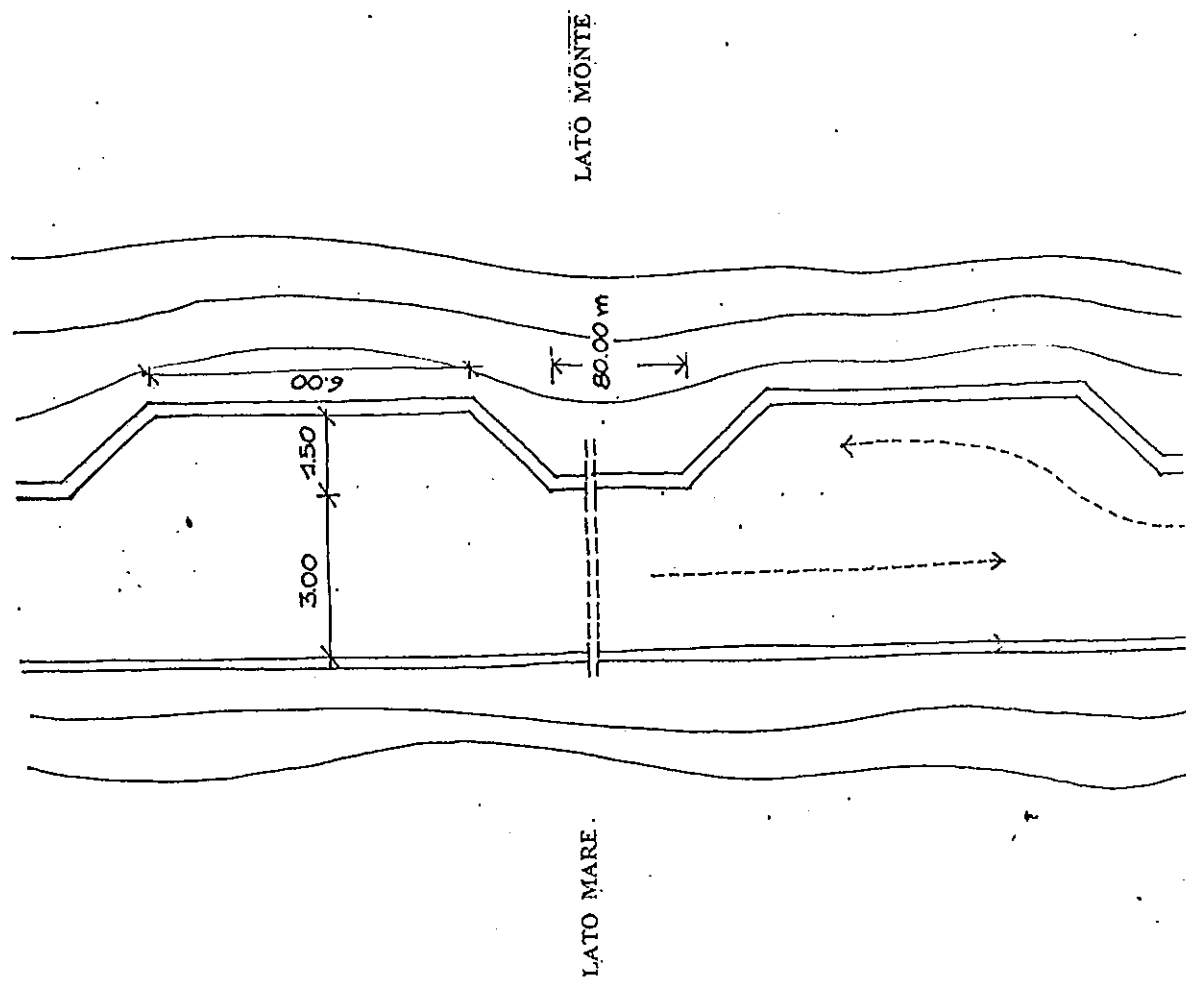

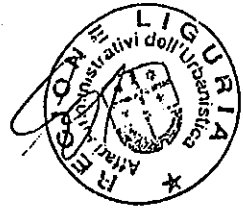

PAESAGGISTICA
AMBIENTALE
N°5 (art. 154)

PROVINCIA DI LA SPEZIA
PIANO REGOLATORE GENERALE

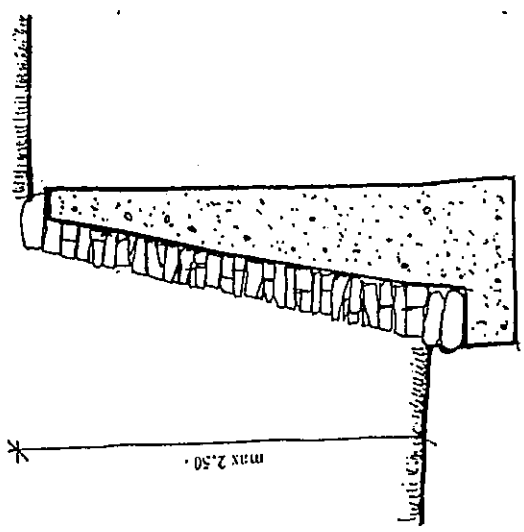
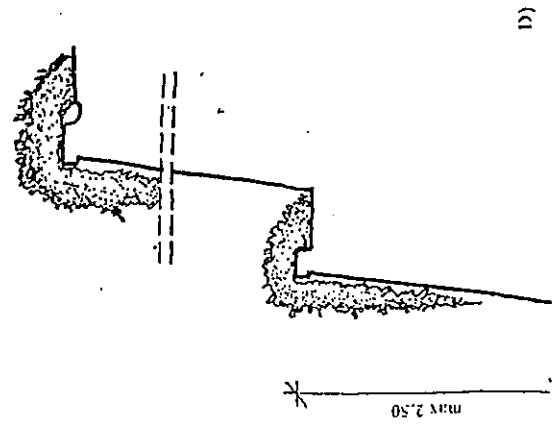
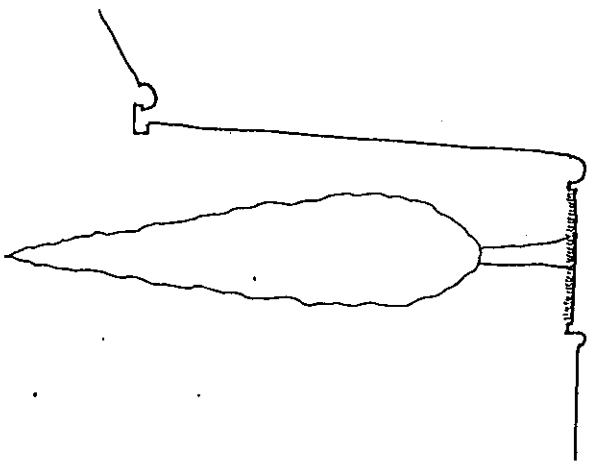
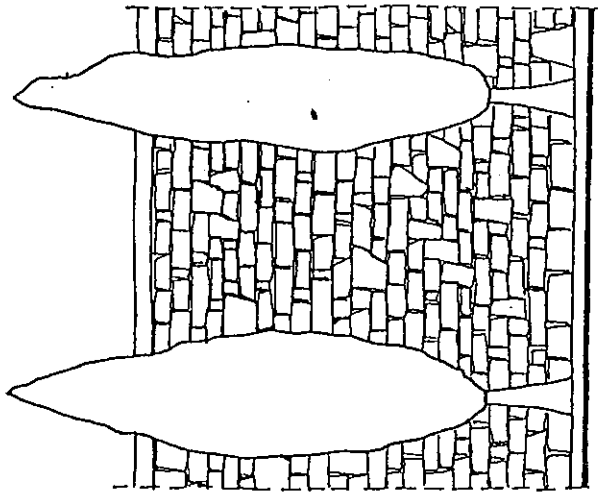
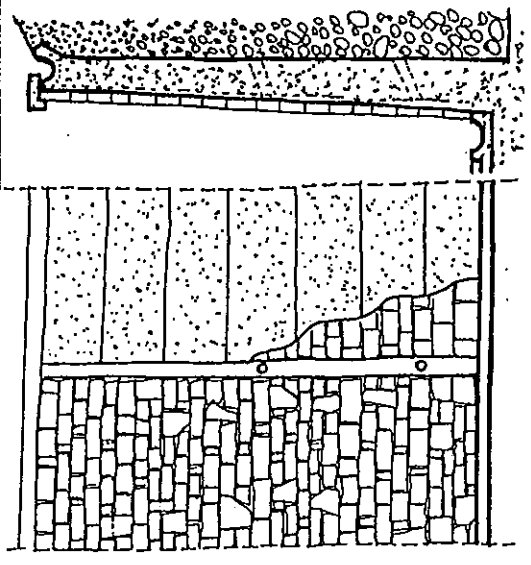

(D)

(B)



COMUNE DI RIOMAGGIORE
 PROVINCIA DI LA SPEZIA
 PIANO REGOLATORE GENERALE

PAESAGGISTICA
 AMBIENTALE
 N°6 (art. 155)

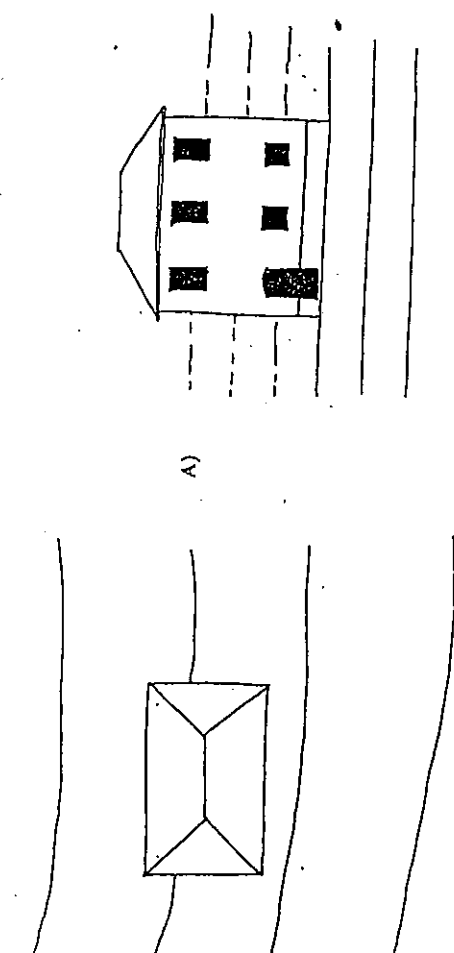

A)

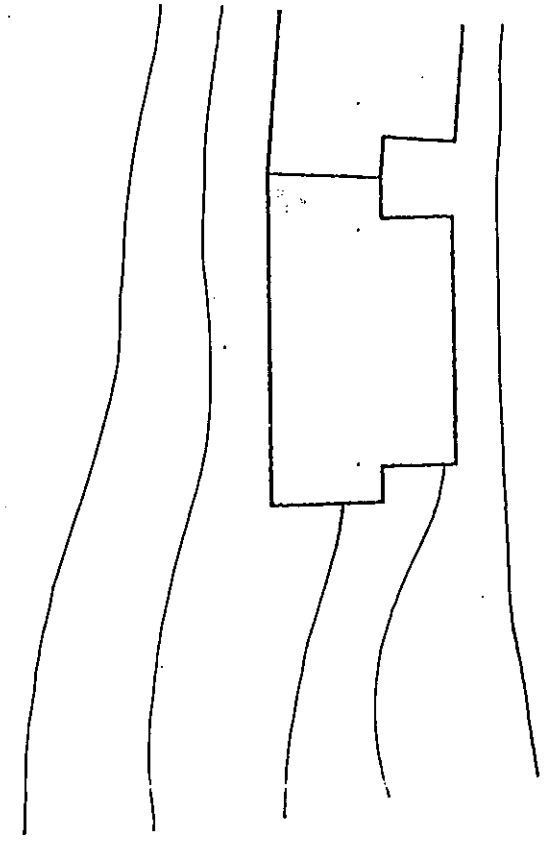

B)

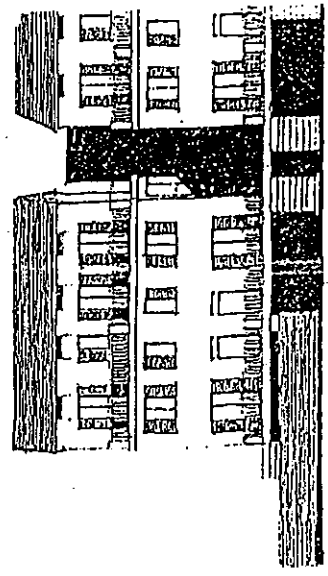
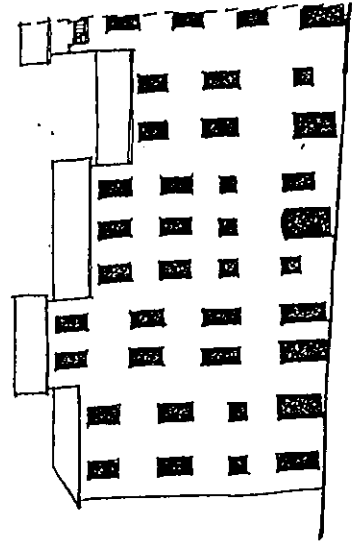
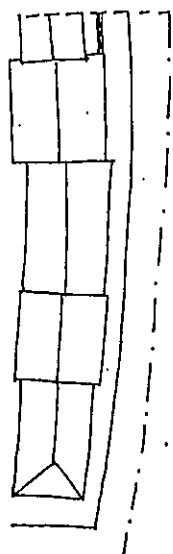



COMUNE DI MONTecatini TERME
 PROVINCIA DI LA SPEZIA
 PIANO REGOLATORE GENERALE

PAESAGGISTICA
 AMBIENTALE
 N°7 (art. 156)

FRONTE SECONDARIO
 PERPENDICOLARE
 ALLE ISOIPSE

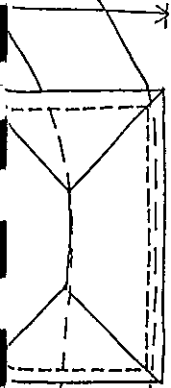

FRONTE PRINCIPALE
 PARALLELO ALLA
 STRADA E/O ALLE ISOIPSE

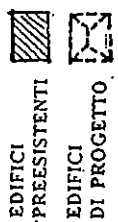

B)

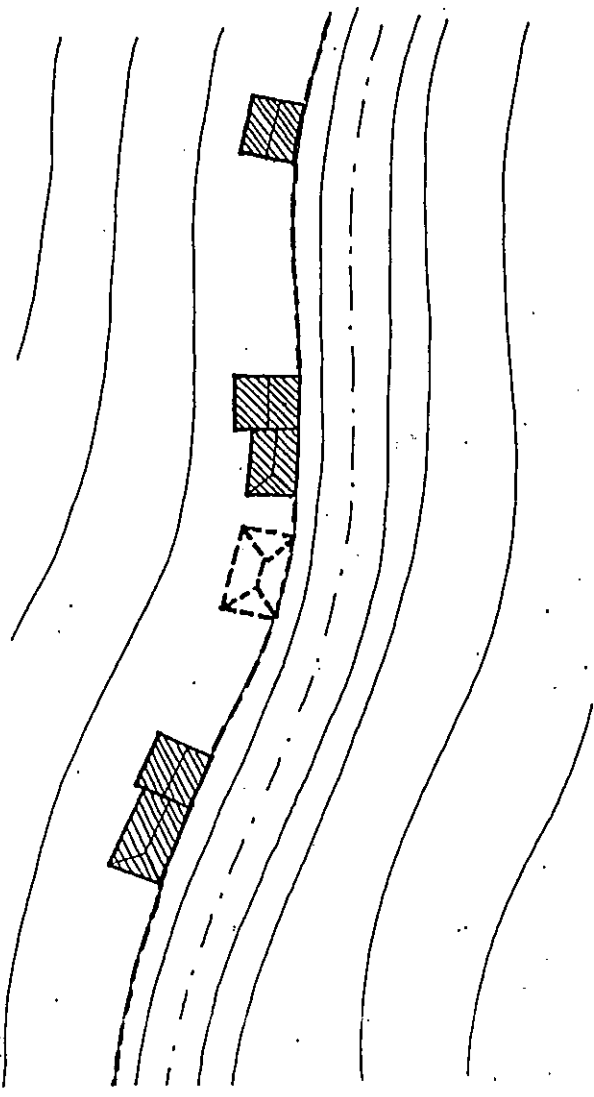

VOLASTRA

ZONA A
 NON EDIFICABILE

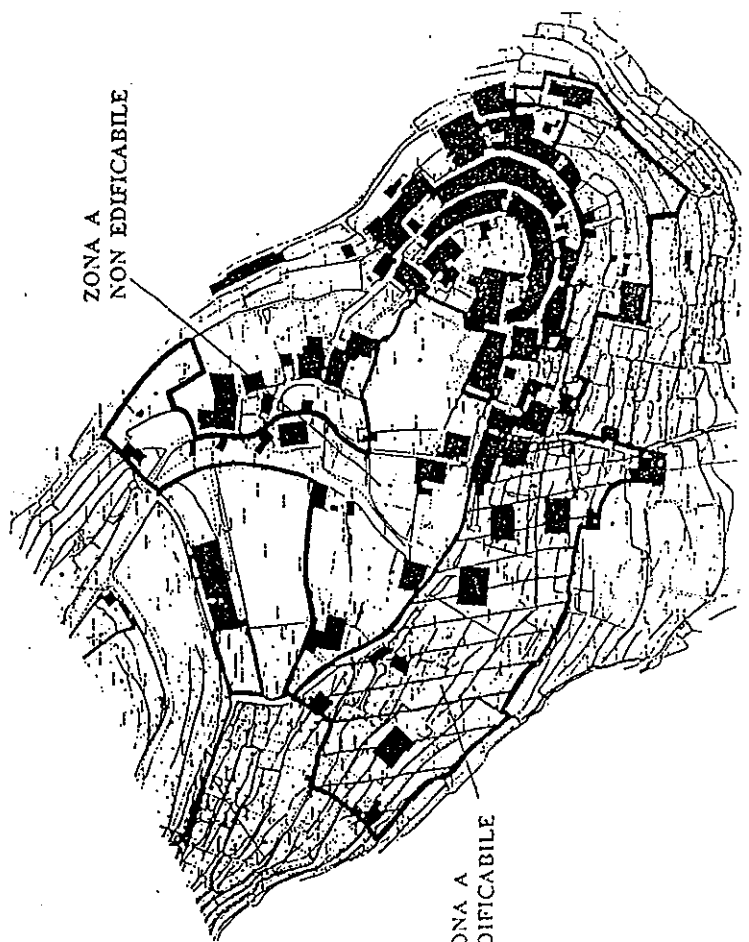

ZONA A
 EDIFICABILE

GROPO

ZONA C DI
 CONCENTRAZIONE
 VOLUMETRICA

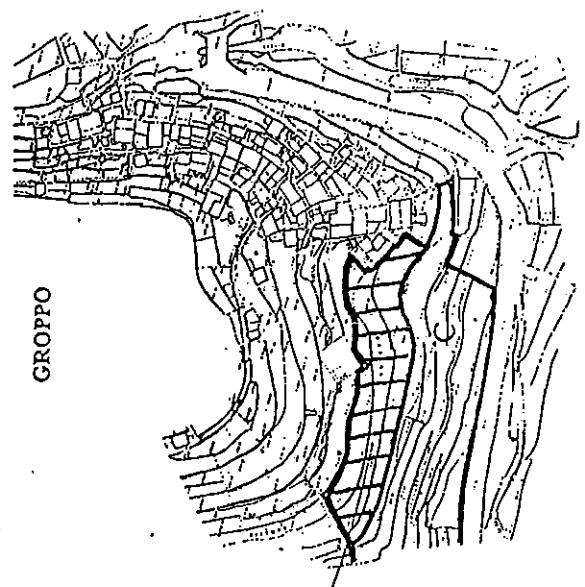



COMUNE DI RIOMAGGIORE
PROVINCIA DI LA SPEZIA
PIANO REGOLATORE GENERALE

SCHEDA NORMATIVA
PAESAGGISTICA
AMBIENTALE
N°8 (art. 157)

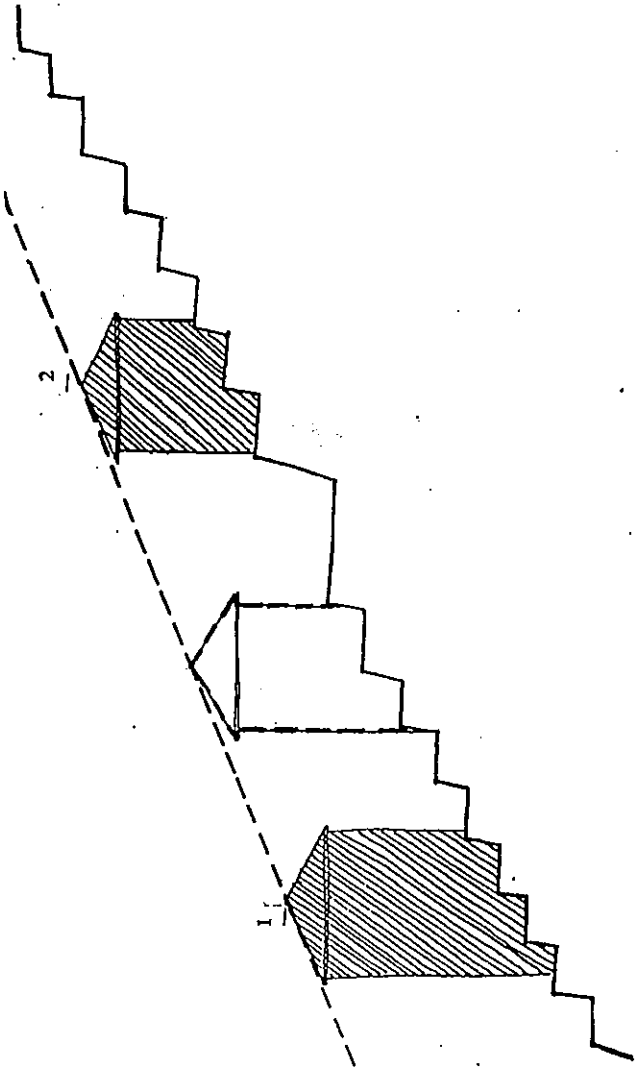
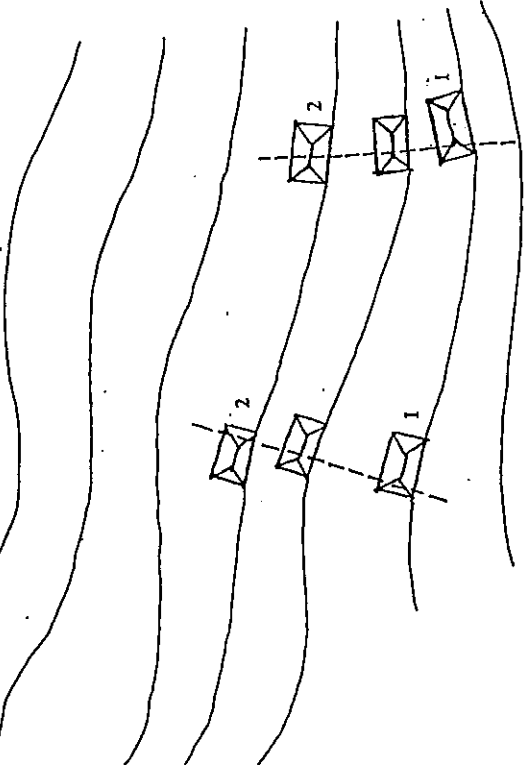

EDIFICI
PREFSISTENTI
EDIFICI
DI PROGETTO

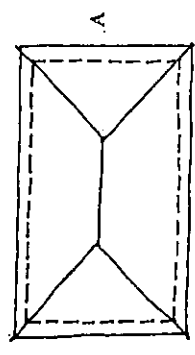

A < B

A = ORTOGONALE ALLE ISOIPSE
B = PARALLELO ALLE ISOIPSE

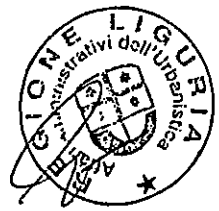

PAESAGGISTICA
AMBIENTALE
N°9 (art.158)

COMUNE DI MONTAVIONE
PROVINCIA DI LA SPEZIA
PIANO REGOLATORE GENERALE

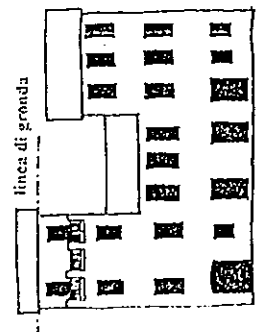
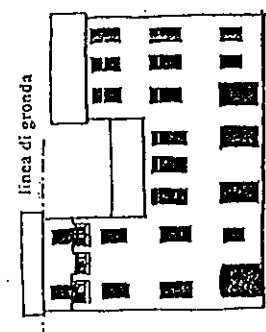
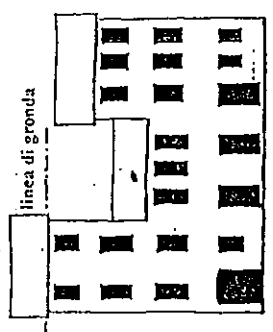
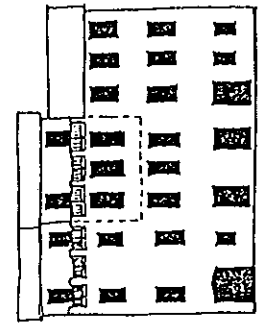
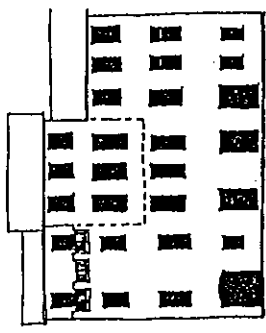
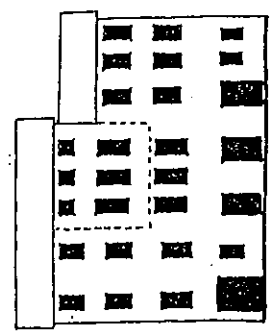
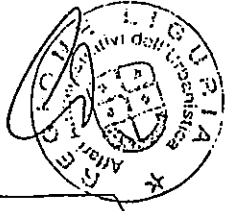
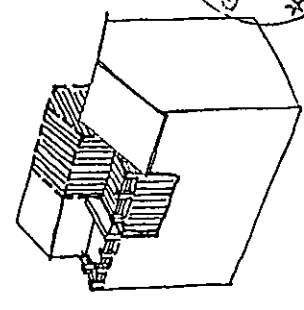
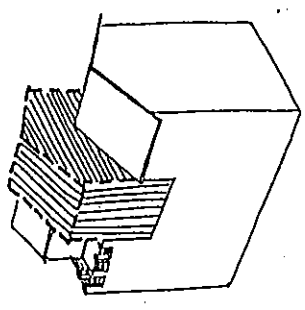
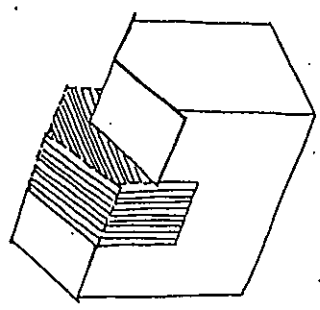

TIPOLOGIE AMMESSE

STATO DI FATTO

SCHEDA NORMATIVA
PAESAGGISTICA
AMBIENTALE
N° 10 (art. 170)

COMUNE DI RIOMAGGIORE
PROVINCIA DI LA SPEZIA
PIANO REGOLATORE GENERALE

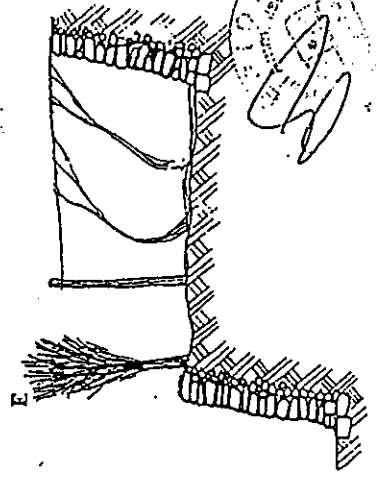
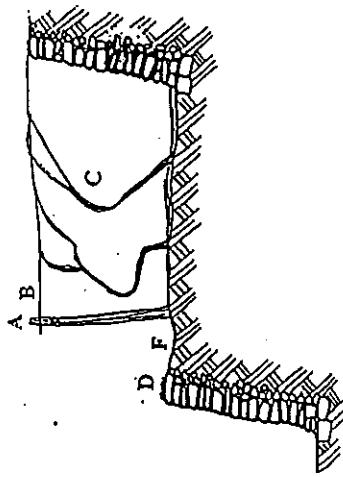
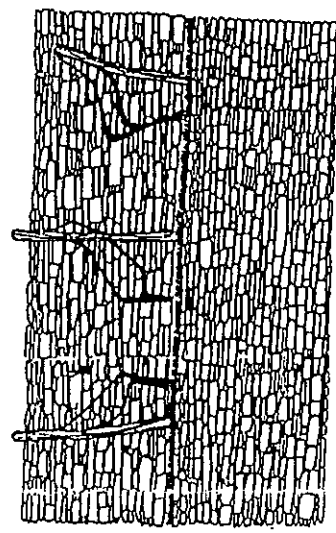
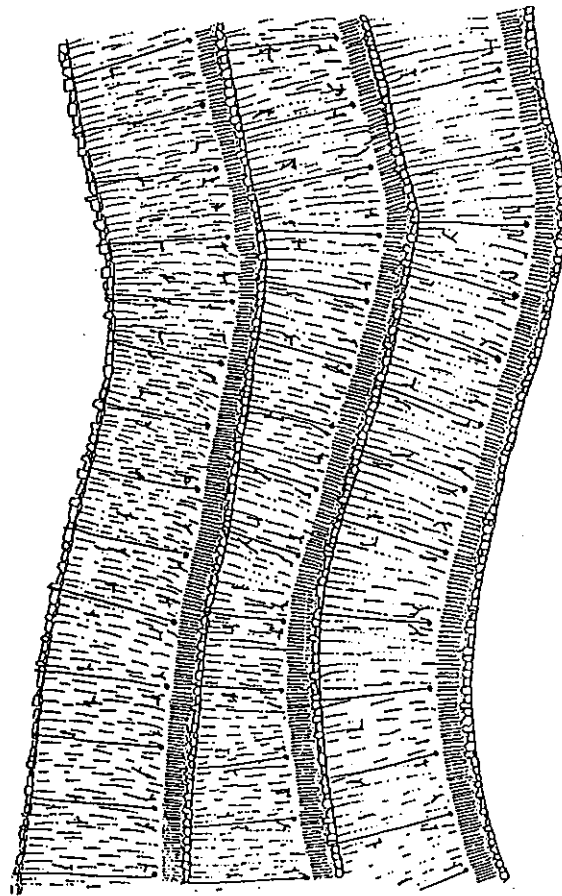

- A: SOSTEGNO IN LEGNO
- B: FILO METALLICO
- C: VITIGNO
- D: TESTA DEL MURO DI FASCIA
- E: PROTEZIONE DAL VENTO E DAL SALINO TRAMITE FASCINE
- F: PERCORSO DI FASCIA

SCHEDA NORMATIVA
PAESAGGISTICA
AMBIENTALE
N° 11 (art. 171)

COMUNE DI RIOMAGGIORE
PROVINCIA DI LA SPEZIA
PIANO REGOLATORE GENERALE

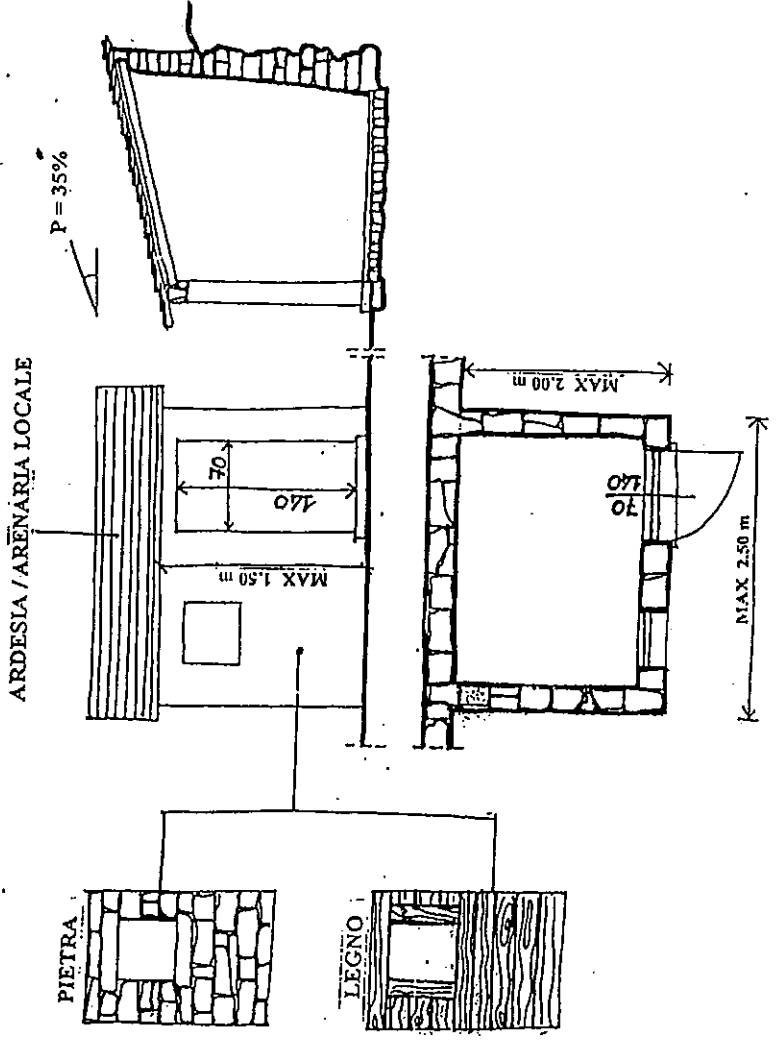
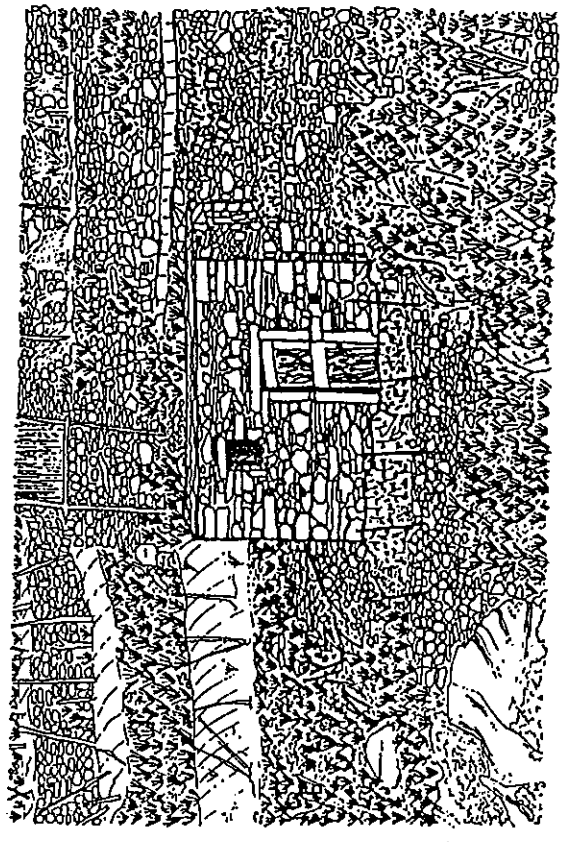
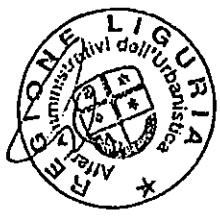



SCHEDA NORMATIVA
PAESAGGISTICA
AMBIENTALE
N° 12 (art. 172)

COMUNE DI RIOMAGGIORE
PROVINCIA DI LA SPEZIA
PIANO REGOLATORE GENERALE

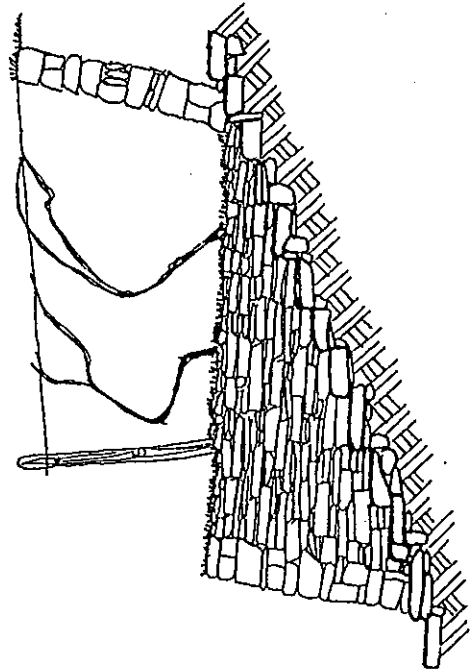
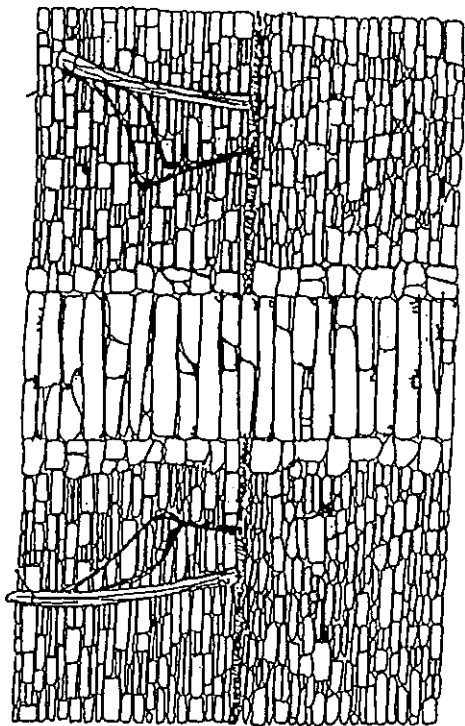

ALZATE E PEDATE IN ARENARIA

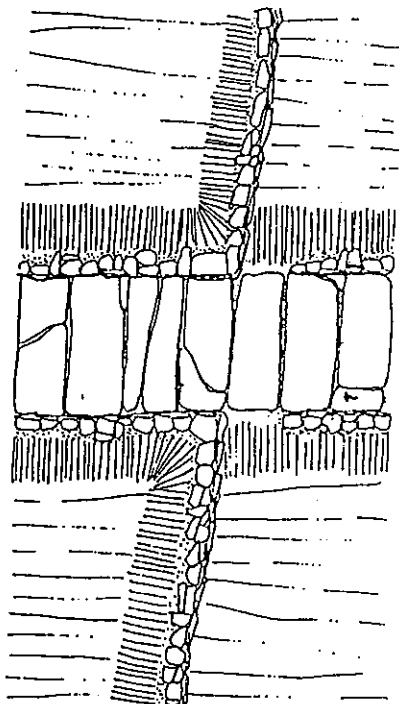



COMUNE DI RIUMAGGIORE
 PROVINCIA DI LA SPEZIA
 PIANO REGOLATORE GENERALE

SCHEDE NORMATIVA
 PAESAGGISTICA
 AMBIENTALE
 N° 13 (art. 175)

TIPOLOGIE AMMESSE NELLA NUOVA EDIFICAZIONE

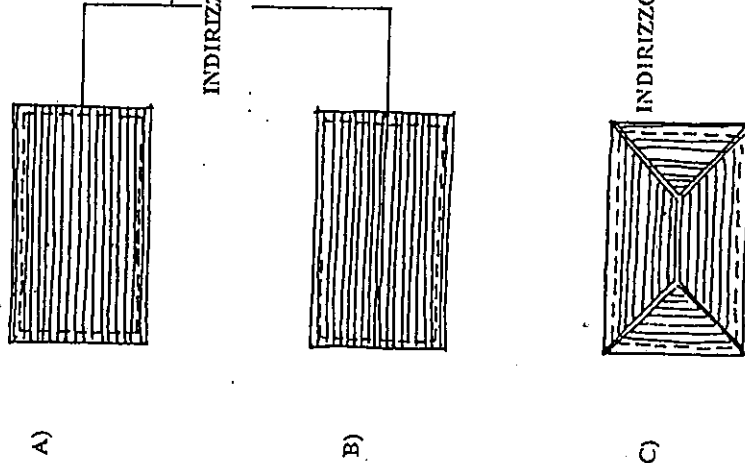
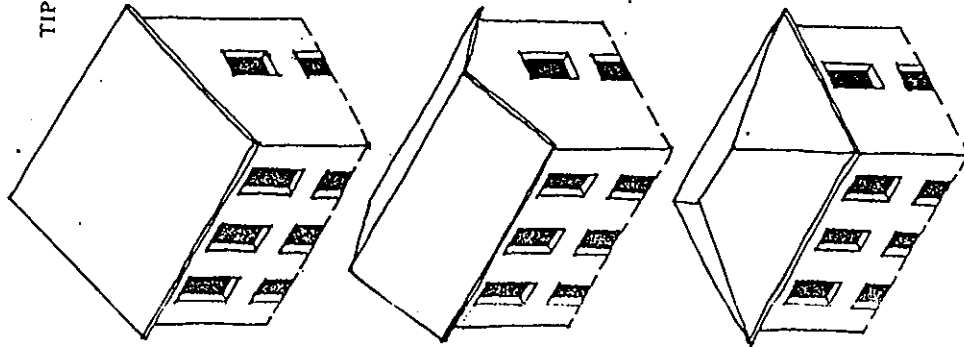
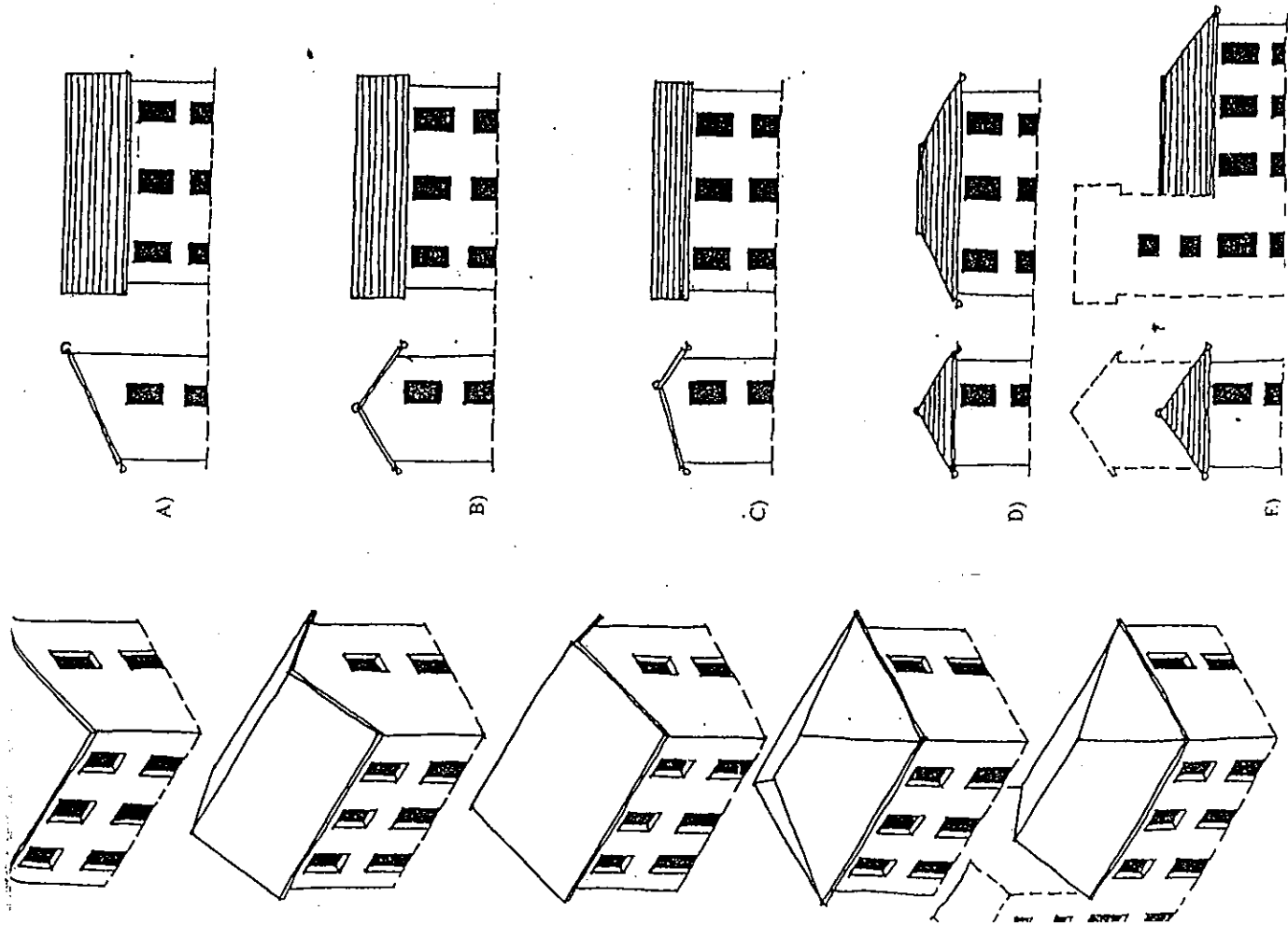

INDIRIZZO PER EDIFICI
 ISOLATI

INDIRIZZO PER EDIFICI
 RESIDENZIALI
 IN PROSSIMITA'
 DEI CENTRI
 ABITATI

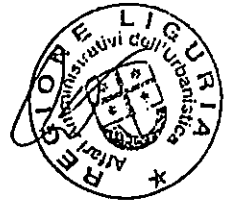

STUDIO S.M.Z.
Sergio Massarente Sergio Zampichelli
Architetti Associati

LUCE ZENITALE

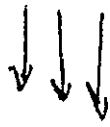

VED. ARTIST.

Lucernario

STRUTTURA METALLICA

MURETTO D'APPESO

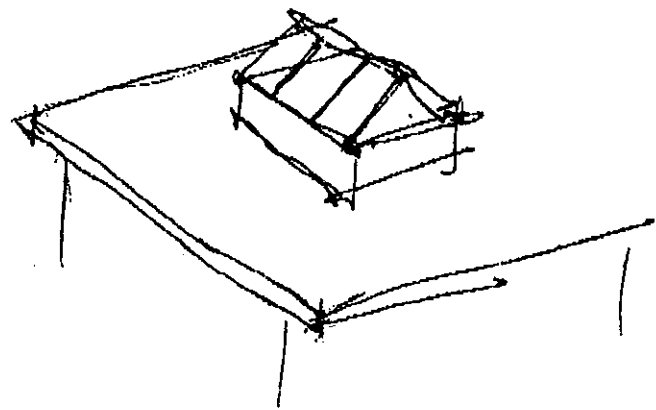
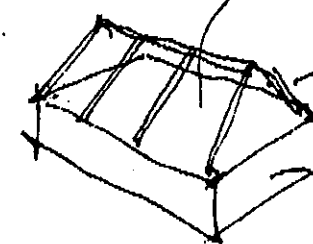
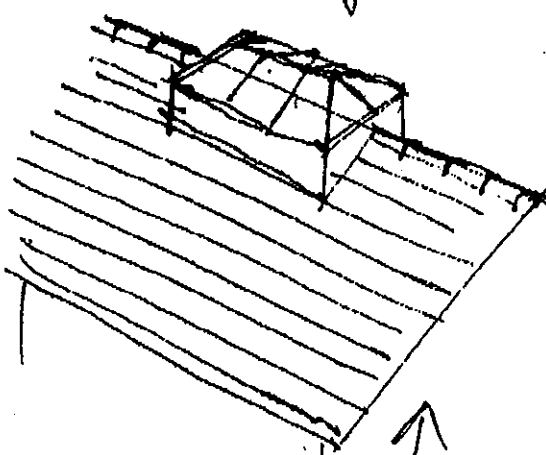

SOLO SU SUPERFICIE
TETTO PIANO

AB. DEVE ESSERE USUFRUITO
DALLA C.E.

FINESTRA "FILO CALDA"
VETATA.

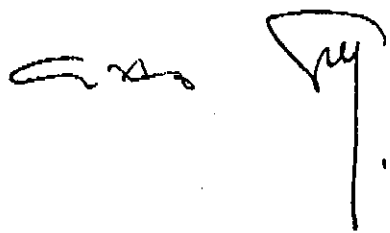
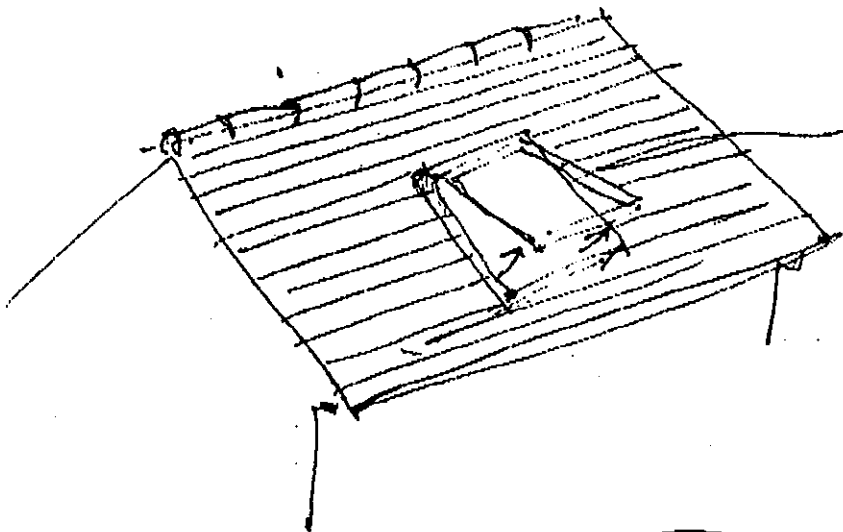



COMUNE DI RIOMAGGIORE
 PROVINCIA DI LA SPEZIA
 PIANO REGOLATORE GENERALE

SCHEDA NORMATIVA
 PAESAGGISTICA
 AMBIENTALE
 N° I4 (art. 176)

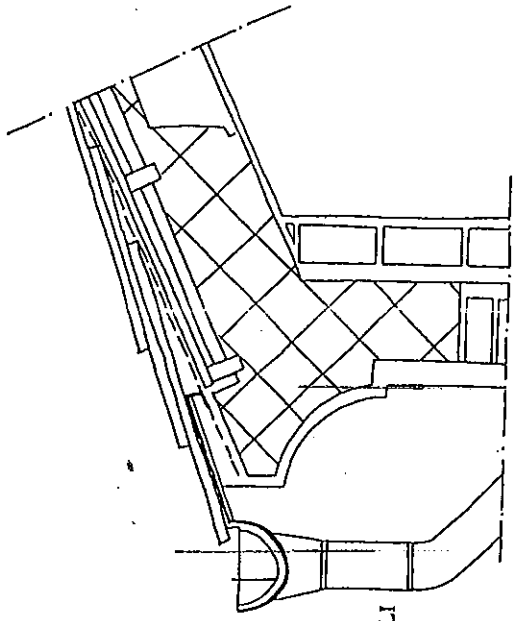

GRONDE E PLUVIALI
 IN RAME

MAX 30 cm
 MAX 50 cm

TIPOLOGIA A CAPANNA
 TIPOLOGIA A PADIGLIONE

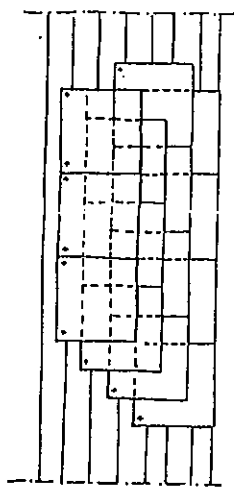

59 cm

59 cm

MANTO DI COPERTURA IN ARDESIA (59 x 59 x 0.51) cm
 SOVRAPPPOSTI DI 1/3, COLMI IN LATERIZIO





COMUNE DI RIOMAGGIORE
PROVINCIA DI LA SPEZIA
PIANO REGOLATORE GENERALE

SCHEDA NORMATIVA
PAESAGGISTICA
AMBIENTALE
N° 15 (art. 178)

CANNA FUMARIA ALLA GENOVESE
IN MURATURA E ARDESIA

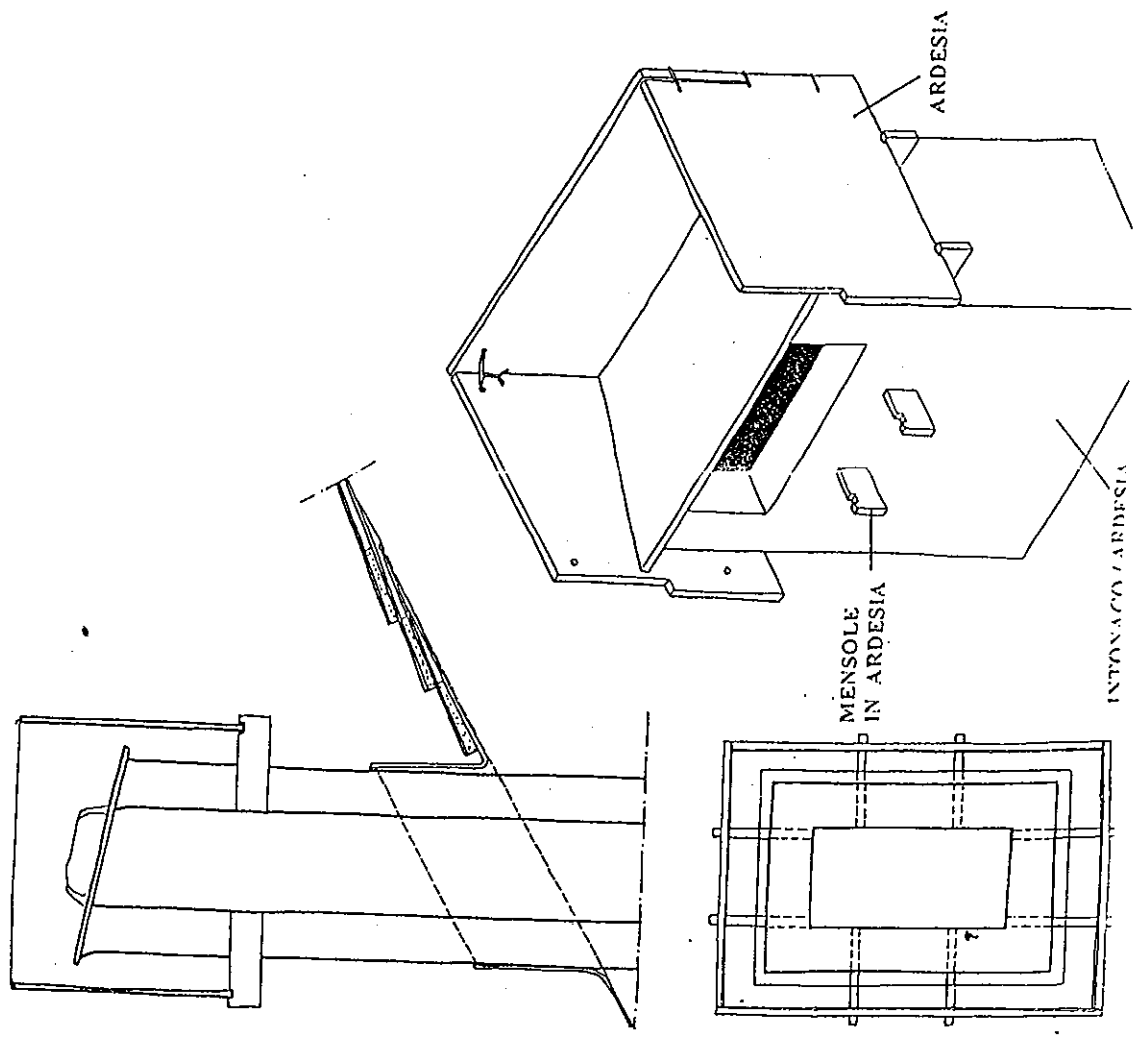



COMUNE DI RIOMAGGIORE
PROVINCIA DI LA SPEZIA
PIANO REGOLATORE GENERALE

SCHEDA NORMATIVA
PAESAGGISTICA
AMBIENTALE
N° 16 (art. 179)

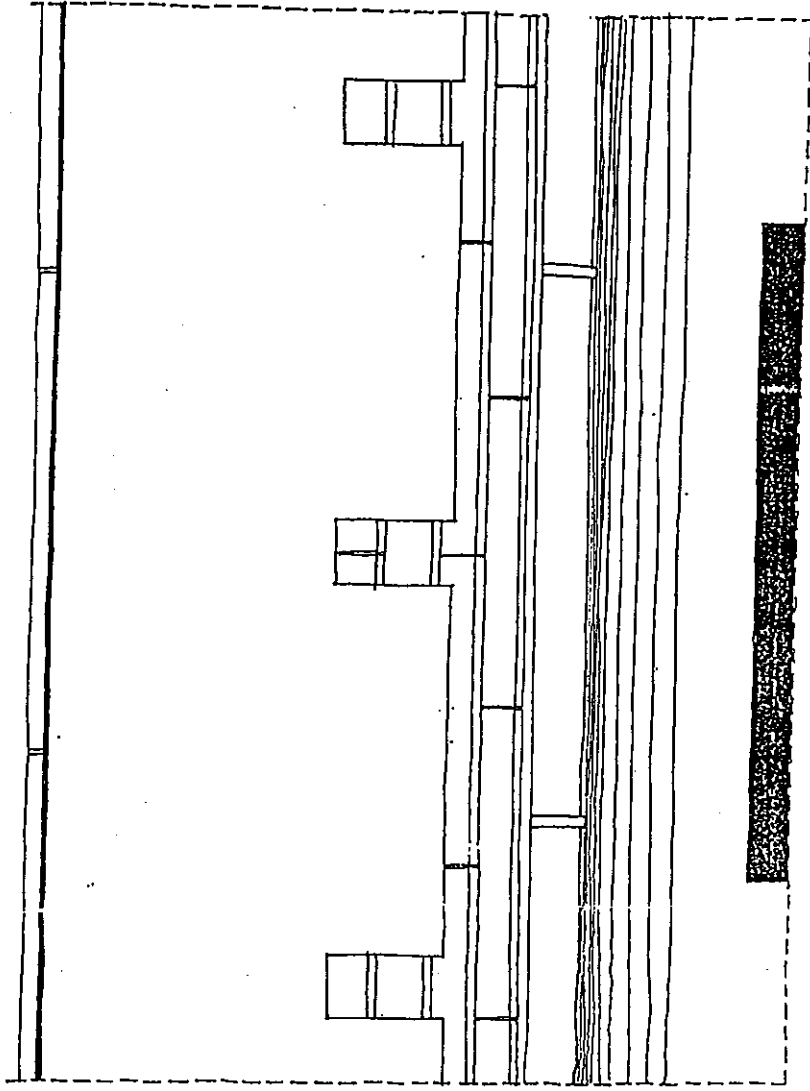

MIN 50 cm.
MAX 80 cm.

PIANA DI ARDESIA

15

Filo fidejussorio

INTONACO ALLA GENOVESE

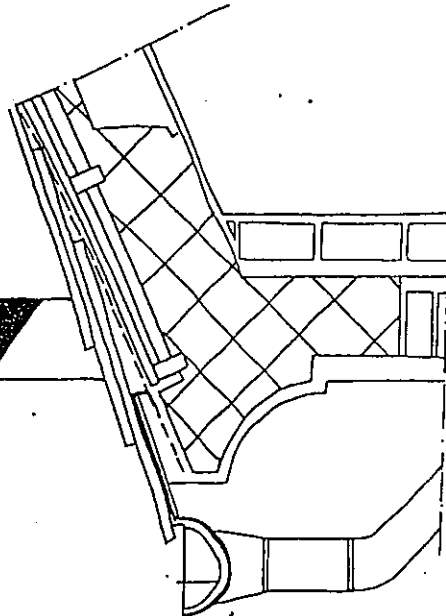



(NO)

ALLINEAMENTO CON LE
BUCATURE DEL FRONTE

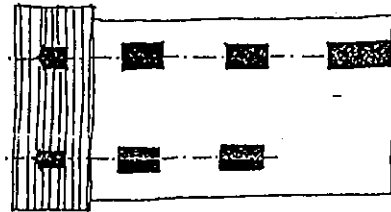

ABBAINO

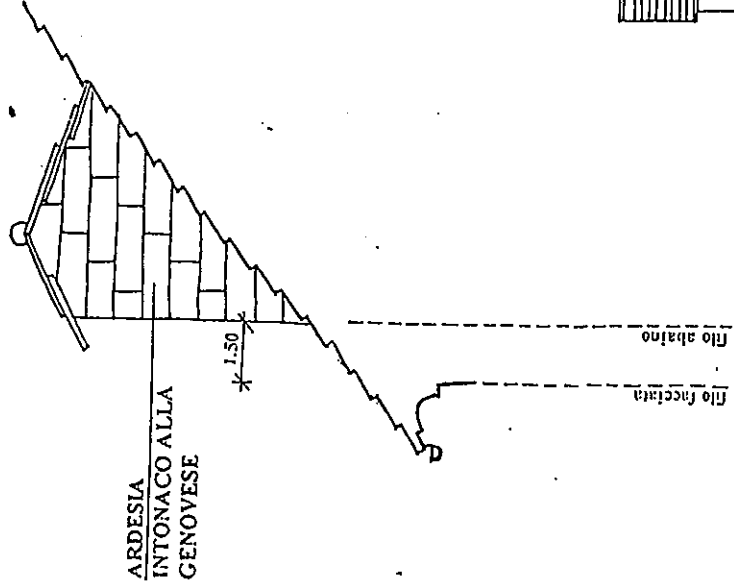
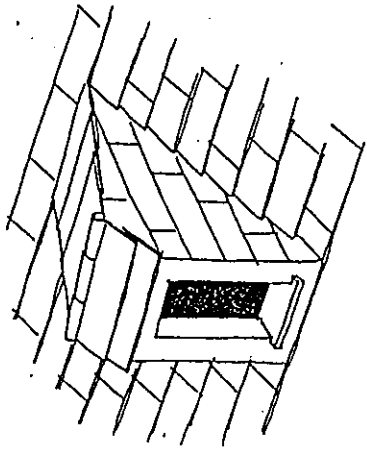

COMUNE DI RIOMAGGIORE
PROVINCIA DI LA SPEZIA
PIANO REGOLATORE GENERALE

SCHEDA NORMATIVA
PAESAGGISTICA
AMBIENTALE
N° 17 (art. 180)

..... IN ARENARIA

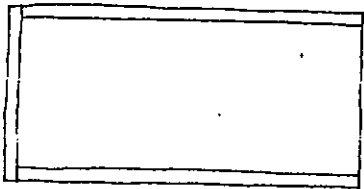

A = MAX 90 cm
B = 210 cm

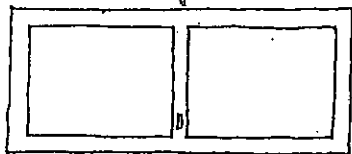

STIPI IN ARENARIA



COMUNE DI RIOMAGGIORE
PROVINCIA DI LA SPEZIA
PIANO REGOLATORE GENERALE

SCHEDA NORMATIVA
PAESAGGISTICA
AMBIENTALE
N°18 (art. 190)

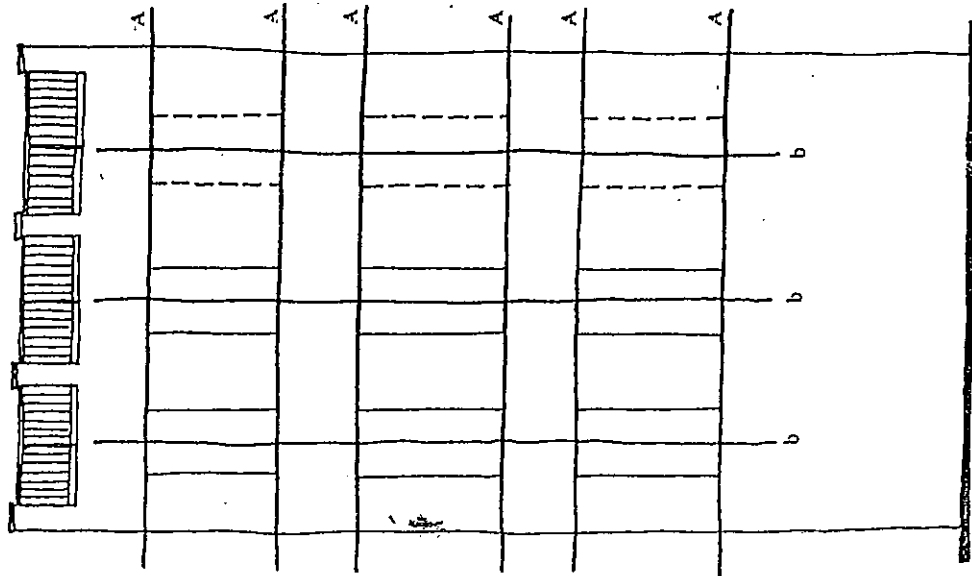

NUOVE
BUCATURE

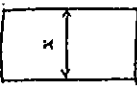
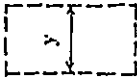

BUCATURE
ESISTENTI

A allineamento orizzontale
b assi verticali
x = larghezza bucatore esistenti
y < x

SOPRALUCE

